

# Flanged-glasses

## Verres de forme relief

### Formproofgläser

### Cristales formproof

### Formproof glas

(GB)

## Flanged-glasses

Formproof glasses are round watch glasses the base of which is very often used to seal the watch case. Since only the top part of the glass protrudes from the case, it gives the impression of an ordinary watch glass. Formproof glasses can be supplied with and without armouring rings.

Glasses without armouring rings can only be fitted watertight into a suitable case with a tightly fitting O-shaped ring.

Armoured Formproof glasses can only be fitted with a very precise fitting tool which does not have any play in the axes (see page 168). To fit the glass, it is pressed into the case from below with pressure plates which are specially made for Formproof glasses. They are graduated in such a way that there is pressure only on the rim of the glass and not on the armouring ring. The case is supported in special plastic pressure plates which leave enough room for the glass when it is being fitted.

These special pressure plates for Formproof glasses are available for both screw presses and lever presses. For details see the end of this catalogue.

Before looking up a particular Formproof glass in this catalogue, please note the detailed instructions on how to measure the case to find the right glass.

(F)

## Verres de forme relief

Les verres de forme relief sont des verres dont la base ronde assure l'étanchéité dans la plupart des cas. La partie en relief sort de la boîte et cette partie visible donne l'impression d'un verre de forme. Les verres de forme relief sont ou ne sont pas équipés d'une bague métallique. Les verres non armés ne peuvent assurer l'étanchéité que si la boîte a été conçue pour recevoir un joint O-Ring bien ajusté. Les verres de forme relief armés ne peuvent être posés qu'avec une presse très précise sans aucun jeu axial (page 168). Le verre se fixe en le chassant à l'intérieur de la boîte. Pour cela il faut utiliser des tasseaux spécialement pour ces verres. Ces tasseaux présentent une creusure calculée de telle manière que la pression s'exerce sur le bord du verre et non sur la bague métallique. La boîte est soutenue par des tasseaux en plastique fraisés spécialement. Cela est nécessaire pour que, lorsqu'on chasse le verre, sa partie relief puisse sortir librement de la boîte.

Les tasseaux spéciaux pour la pose des verres de forme relief sont livrables pour les presses à levier comme pour les presses à vis. Vous en trouverez les détails à la fin du catalogue.

Avant de chercher un verre de forme relief dans ce catalogue, il faut mesurer la boîte puis tenir compte des instructions de classification pour découvrir le verre.

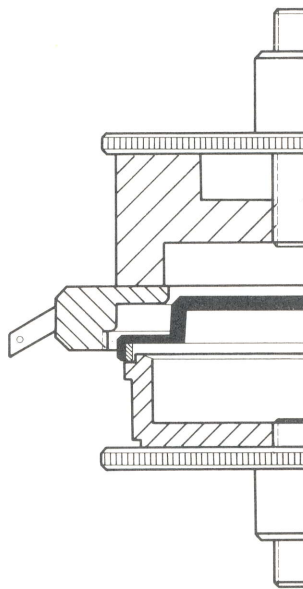

# F Formproof · Forme-relief

ordering-number  
 numéro pour la commande  
 Bestellnummer  
 número para el pedido  
 beställningsnummer

Identification letters for the part of the form  
 Lettre d'identification désignant la forme  
 Kennbuchstaben für den Formteil  
 Letras de identificación para la parte de forma  
 Bokstavsbeteckningar för formdelar

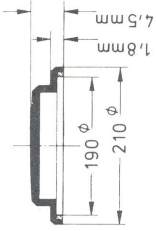
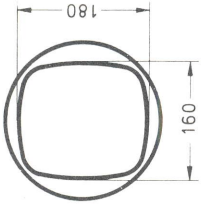

## FBA 210.951

Page  
 Page  
 Seite  
 Pagina  
 Sidan

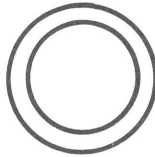

**FO**

round  
 rond  
 rund  
 redondo  
 rund

74

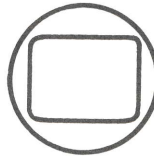

**FR**

Rectangular shape  
 Forme rectangulaire  
 Rechteckform  
 Forma rectangular  
 Rektangelform

74

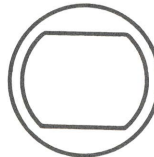

**FT**

Barrel shape  
 Forme tonneau  
 Tonnenform  
 Forma de barril  
 Tunntorm

77

**A** with ring  
 avec bague  
 mit Ring  
 con arillo  
 med ring

2 sides bended, 2 sides straight – 2 côtes cambrés, 2 côtes droites – 2 Seiten gebogen, 2 Seiten gerade, 2 lados curvos, 2 lados planos – 2 sidor väll-da, 2 sidor raka

**FB**

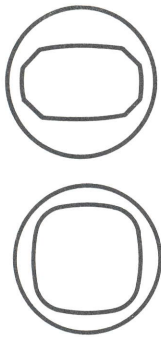

All 4 sides bended – les 4 côtes cambrés – alle 4 Seiten gebogen – todos los 4 lados encovados – alle sidor vâlvda

Bale shape  
Forme balle  
Ballenform  
Forma de fardo  
Ballenform ..... 97

**FE**

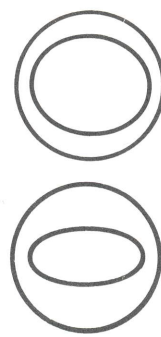

Elliptical shape  
Forme elliptique  
Ellipsenform  
Elíptico  
Ellipsform ..... 129

**FH**



Horseshoe and other shapes  
Forme fer à cheval et autres formes  
Hufeisen- und sonstige Formen  
Forma de herradura y otros formas  
Hov- och övriga former ..... 142

Within one form the glasses are classified according to the outside diameter  
A l'intérieur d'une même forme les verres sont classés d'après les diamètres extérieurs  
Innerhalb einer Form sind die Gläser nach dem Außendurchmesser geordnet  
Dentro de una forma, los cristales se ordenan de acuerdo a su diámetro exterior  
Glasen med samma former är ordnade efter ytterdiameter

Within one diameter the glasses are classified according to the maximum size of the part of the form  
A l'intérieur d'un même diamètre les verres sont classés d'après la plus grande dimension de la forme  
Innerhalb eines Durchmessers sind die Gläser nach dem Größtmaß des Formteils geordnet  
Dentro de un diámetro, los cristales se ordenan de acuerdo a la medida mayor de la forma  
Invändig diameter ordnade efter största mått

FO

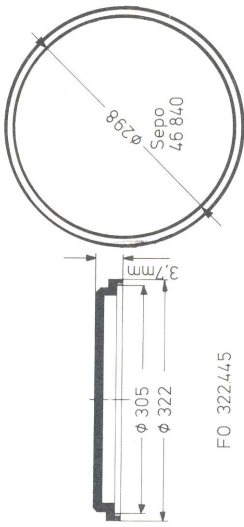
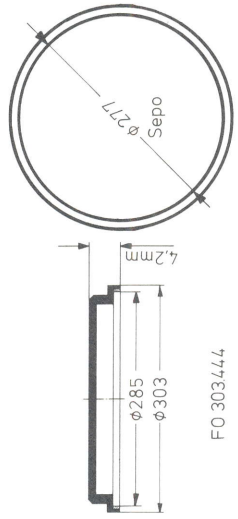

FR ↓

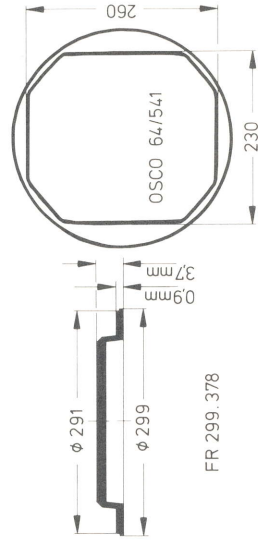
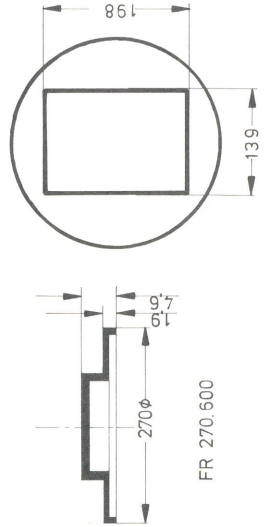
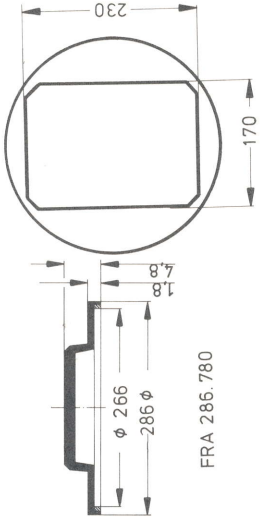
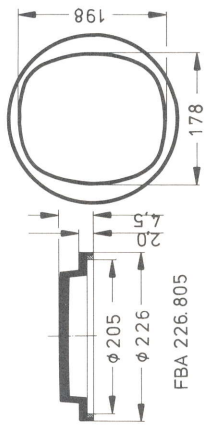

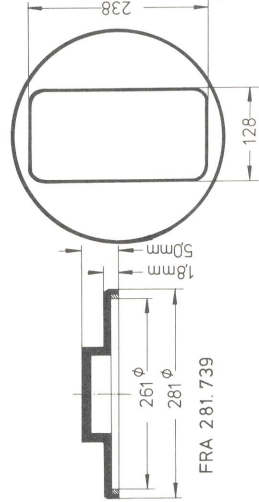
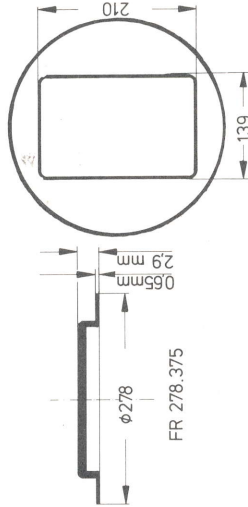
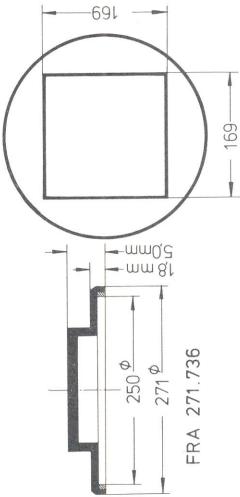
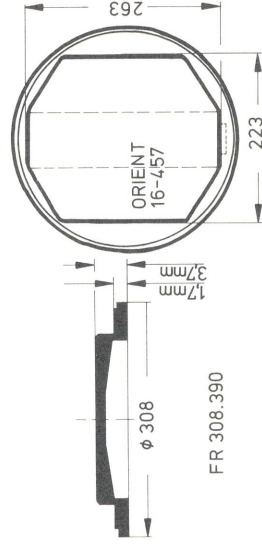
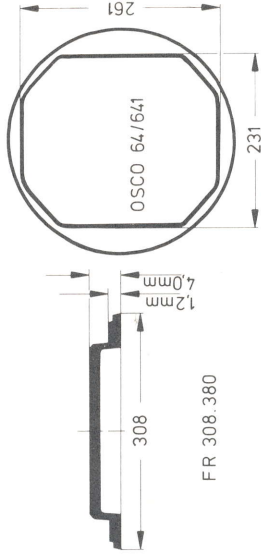
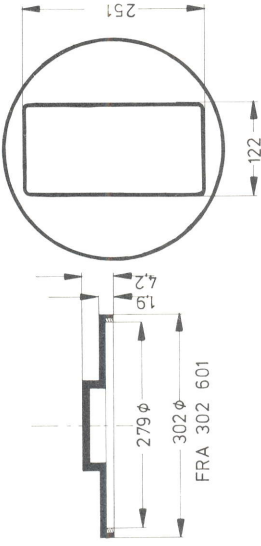

**A** = with ring – avec bague – mit Ring – con arillo – med ring

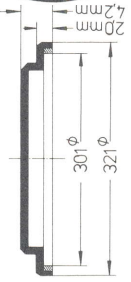
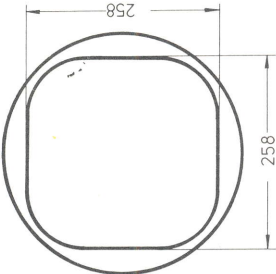

FRA 321.741

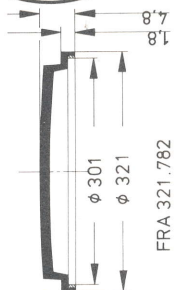
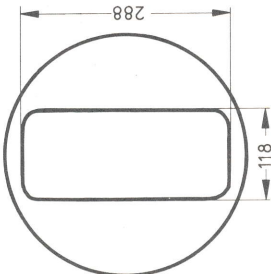

FRA 321.782

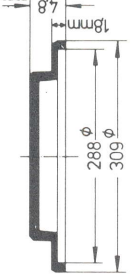
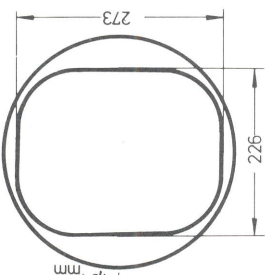

FTA 309.715

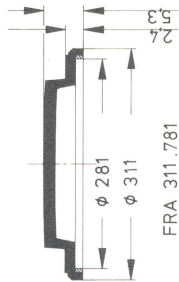
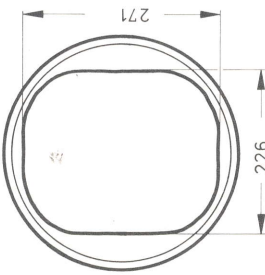

FRA 311.781

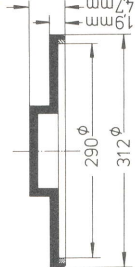
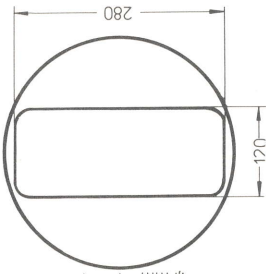

FRA 312.742

FR ↓



FT ↓

↓

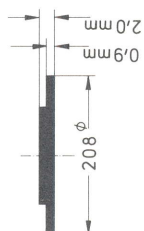
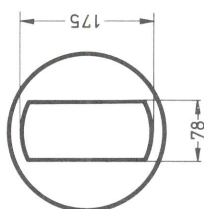

FT 208.945

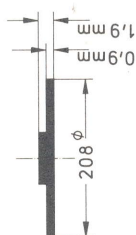
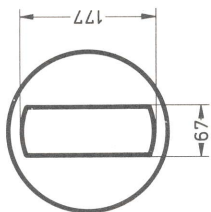

FT 208.941

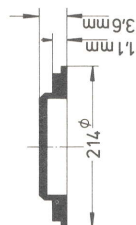
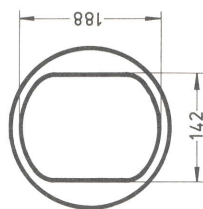

FT 214.757

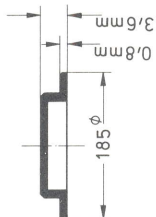
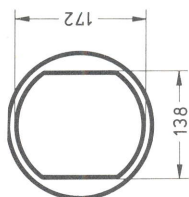

FT 185.946

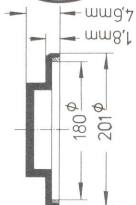
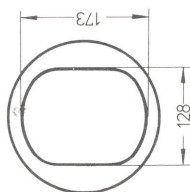

FTA 201.733

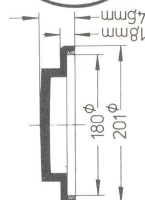
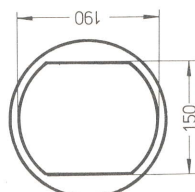

FTA 201.720

**A** = with ring – avec bague – mit Ring – con arillo – med ring

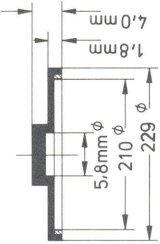
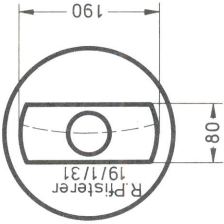

FTA 229.963

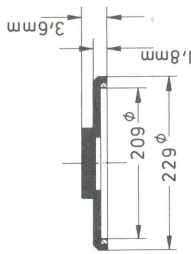
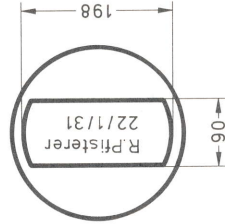

FTA 229.971

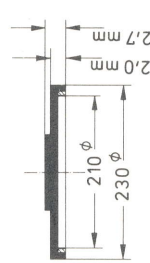
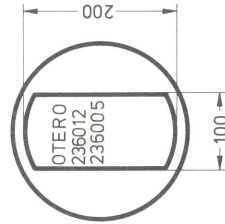

FTA 230.939

FT ↓

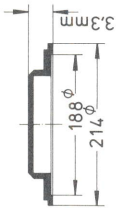
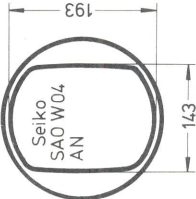

FB 214.302

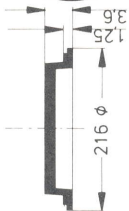
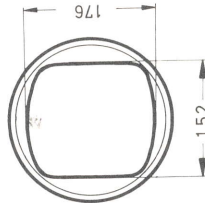

FT 216.414

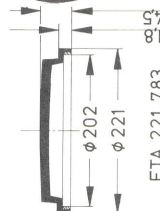
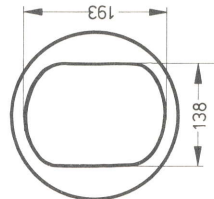

FTA 221.783

↓



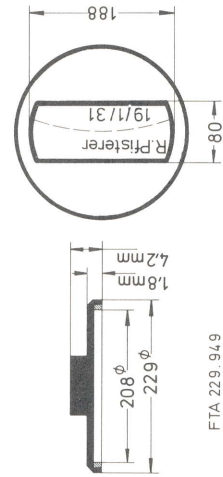
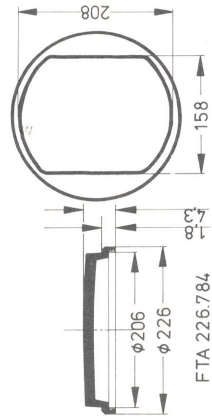
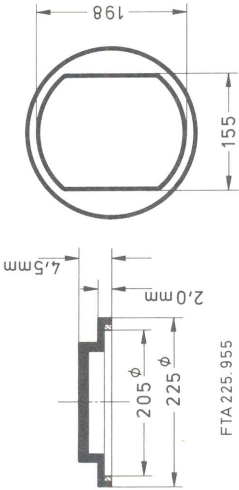
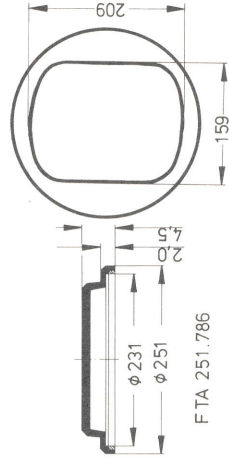
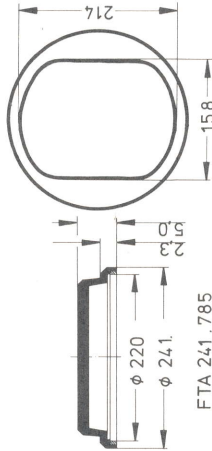
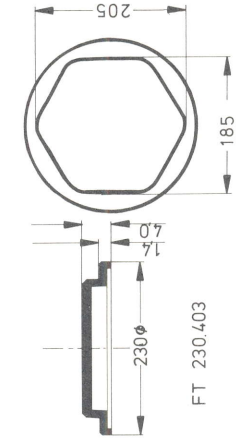

**A** = with ring – mit Ring – con arillo – med ring  
 = avec bague – mit Ring – con arillo – med ring

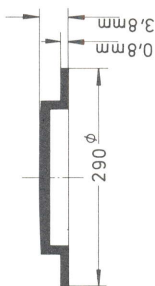
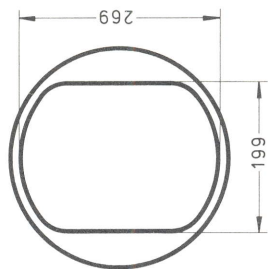

FT 290.771

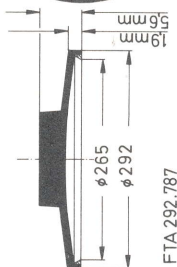
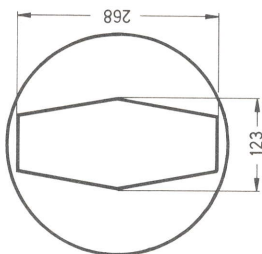

FTA 292.787

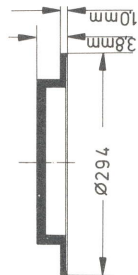
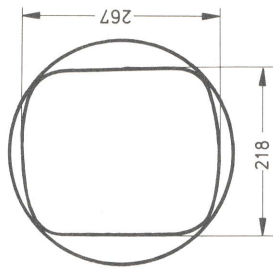

FT 294.341

FT ↓

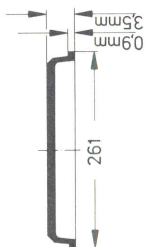
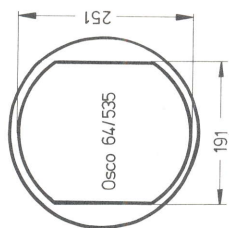

FT 261.376

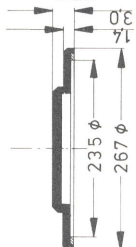
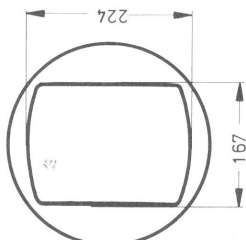

FTA 267.425

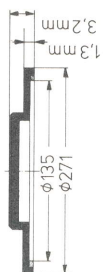
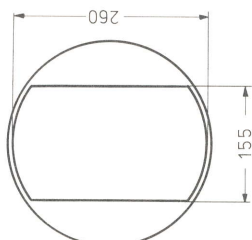

FT 271.433

↓

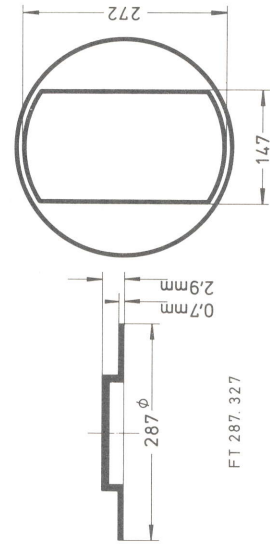
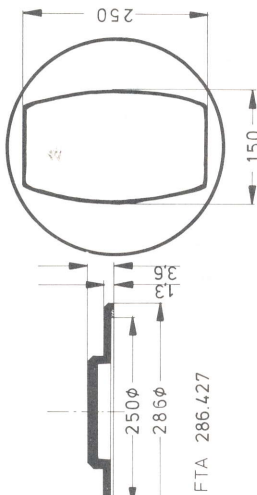
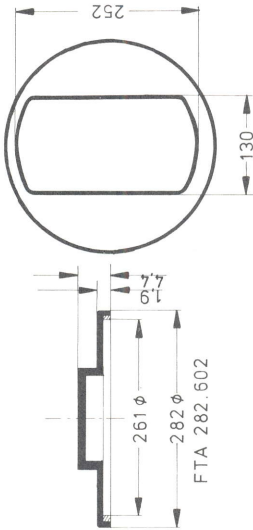
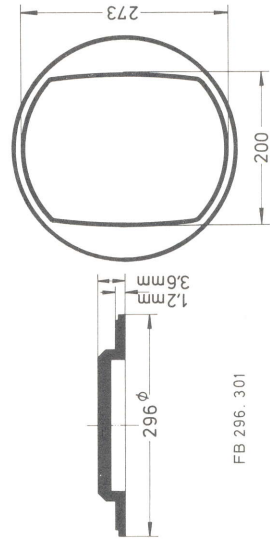
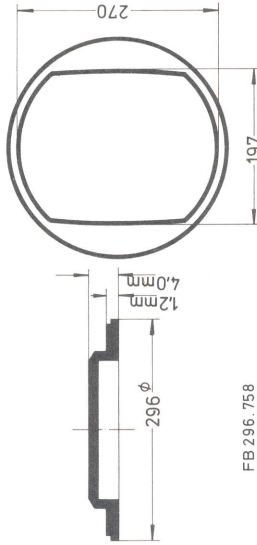
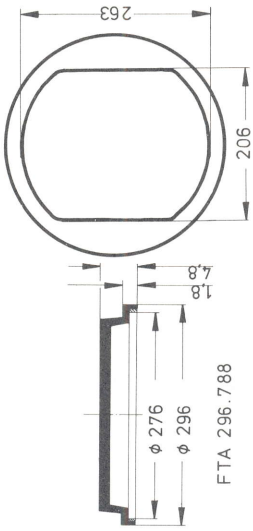

**A** = with ring – avec bague – mit Ring – con anillo – med ring

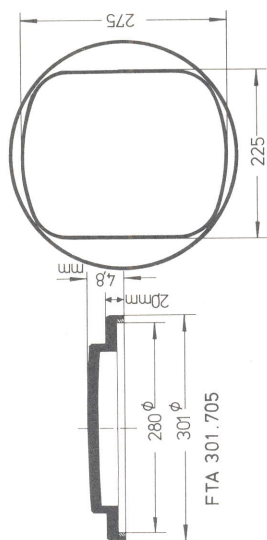

FTA 301.705

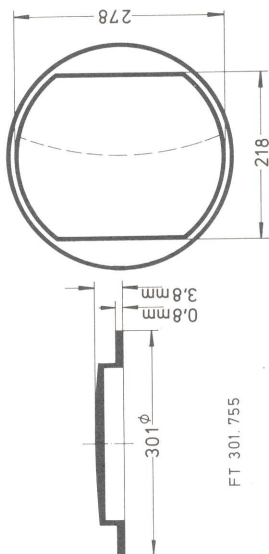

FT 301.755

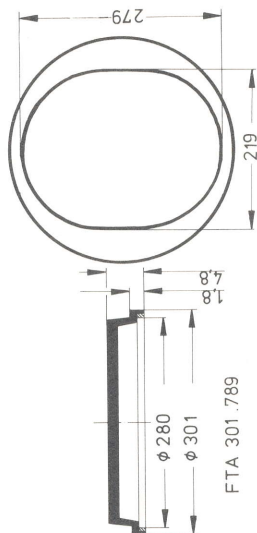

FTA 301.789

FT ↓

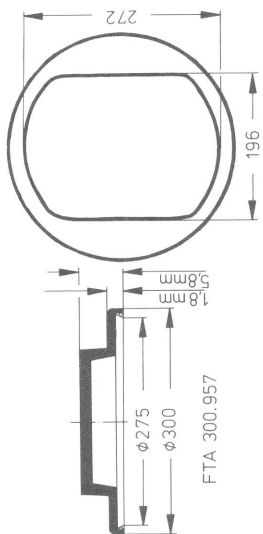

FTA 300.957

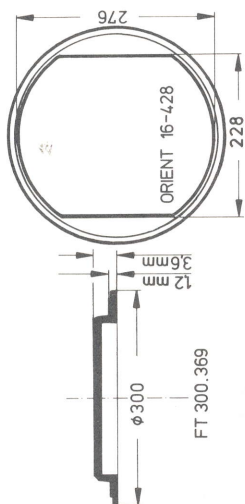

FT 300.369

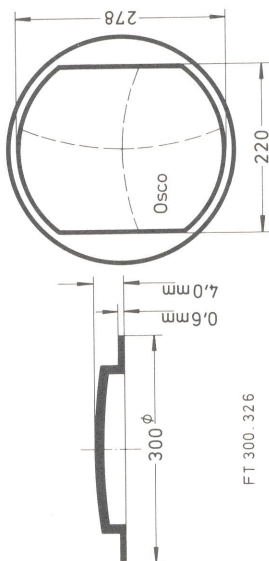

FT 300.326

→

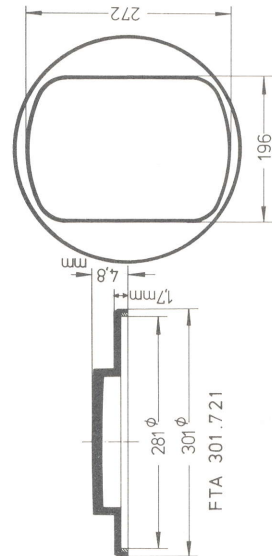
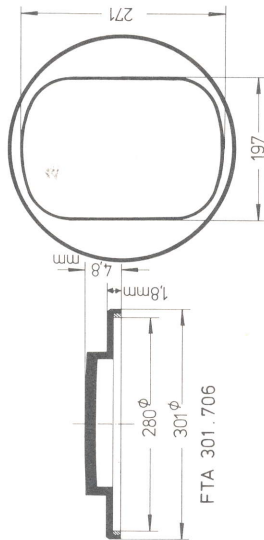
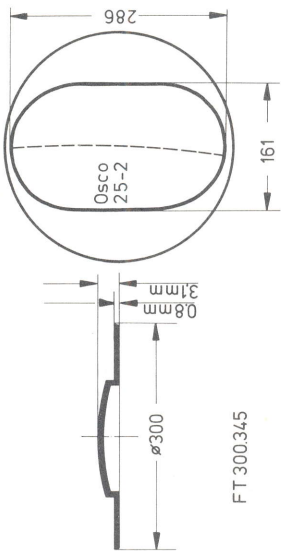
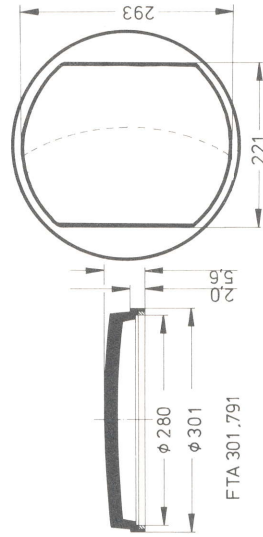
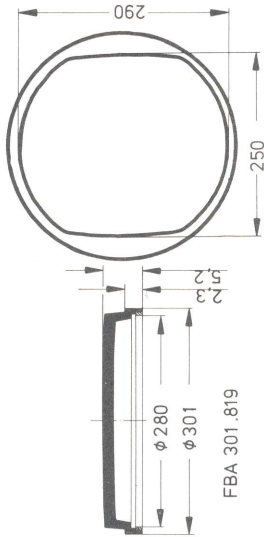
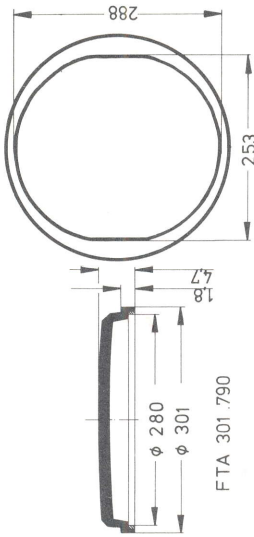

**A** = with ring – avec bague – mit Ring – con arillo – med ring

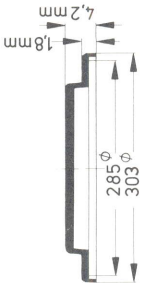
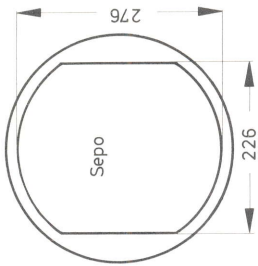

FTA 303.966

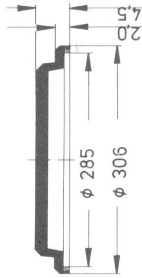
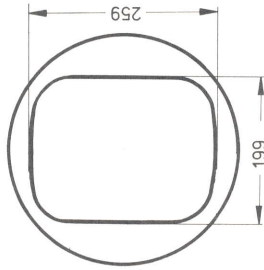

FTA 306.792

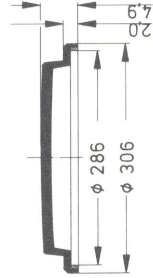
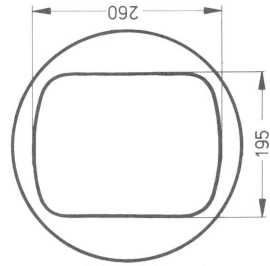

FTA 306.793

FT ↓

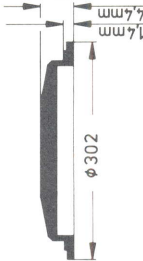
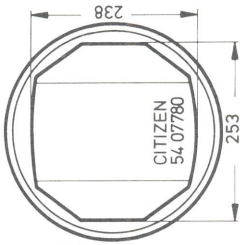

FT 302.374

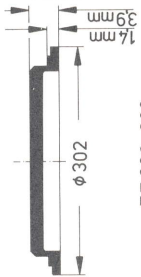
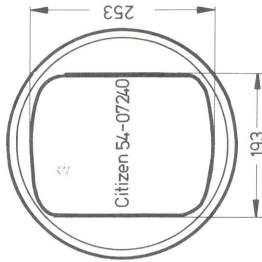

FT 302.388

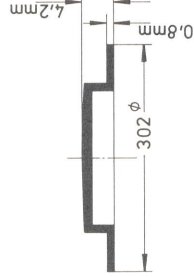
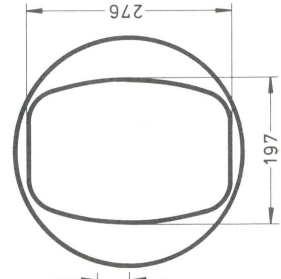

FT 302.312

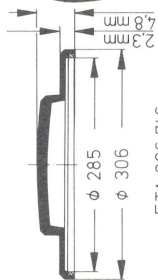
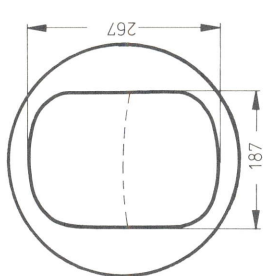

FTA 306.746

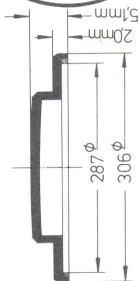
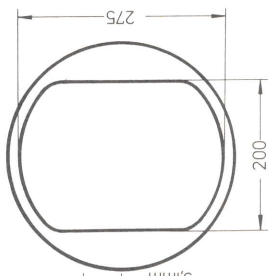

FTA 306.743

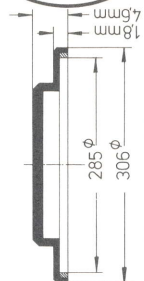
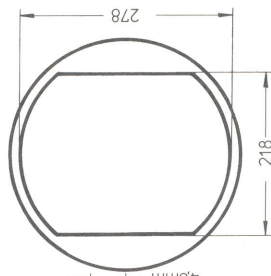

FTA 306.735

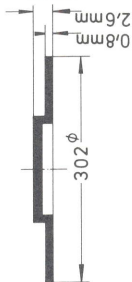
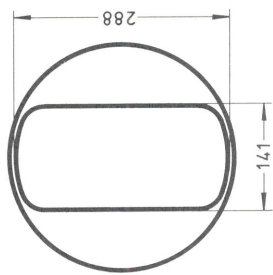

FT 302.304

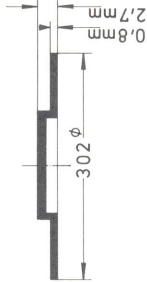
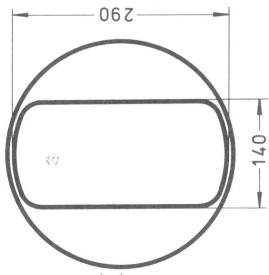

FT 302.331

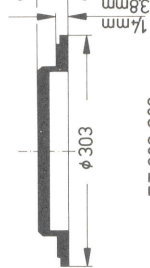
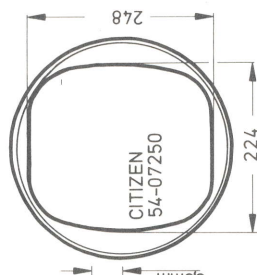

FT 303.389

**A** = with ring – avec bague – mit Ring – con arillo – med ring

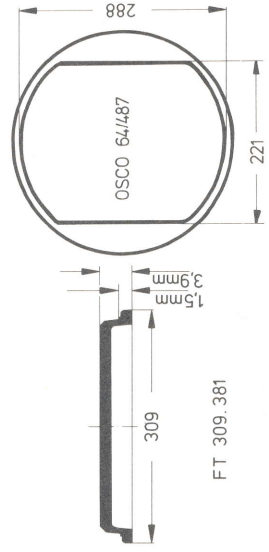
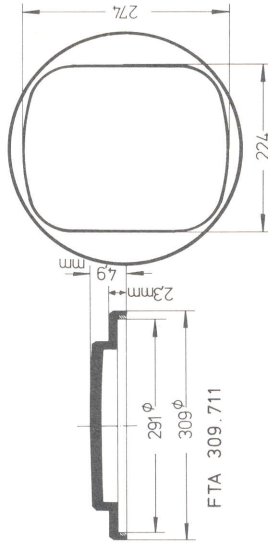
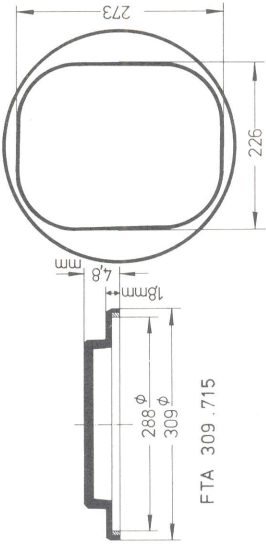

FT ↓

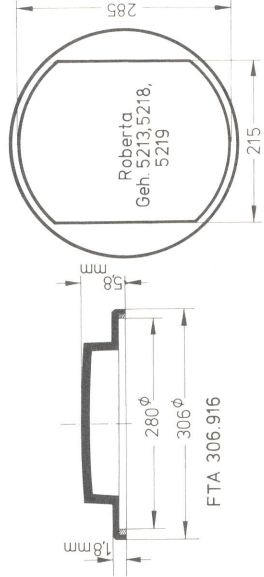
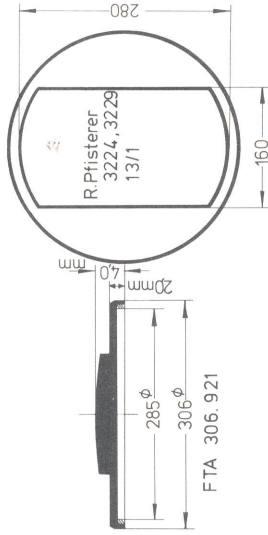
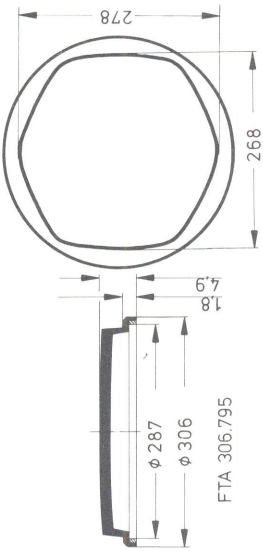

↓